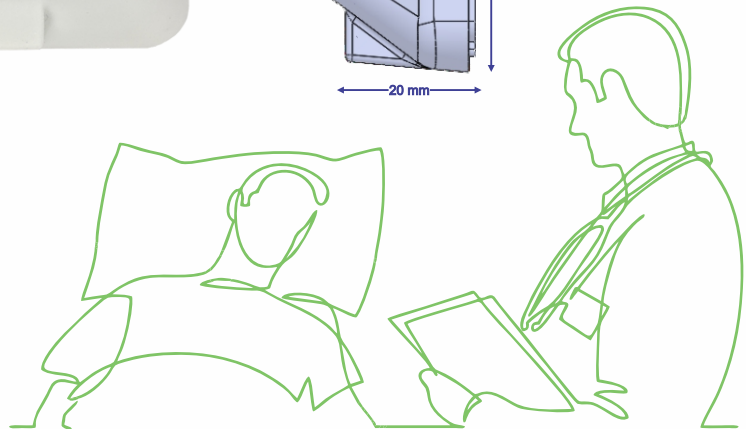
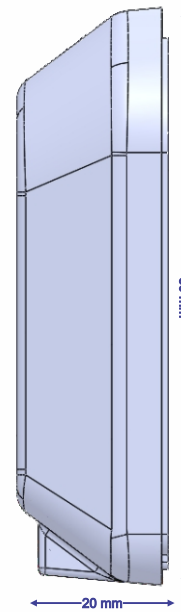

**WIRELESS NCS - PATIENT PANEL (WB-01/P)**

WB-01/P comes with an RJ11 socket for Pear push Switch (PBW-01). It also has a Nurse Call and a Cancel/Presence Switch onboard.

It is powered by a 12 V Alkaline Battery and also comes with the external 12 VDC power adapter version (WB-01/P) to eliminate the battery life issue.

It can be installed easily next to patient's bed regardless of the wiring layout of the facility.

**Technical Specifications:**

Weight	60 g		
Dimensions	W:80 mm	H:80 mm	D: 20 mm
Raw Material	Polycarbonate + ABS		
Color	White		
Port	RJ11		
Power Supply	12 V Battery(WB-01) / 12 V DC external Adapter(WB-01/P)		
Battery Type	23A Alkaline		
Battery Life	6 months		
Wireless Range	100 meters radius outdoors		
Wireless Frequency	433 MHz		
Operating Temperature	-10°C ~ +50° C		
Operating Humidity	30% ~ 80% RH		
Mounting	Flush/Surface		