

BASIC NCS-PATIENT PANEL (PBCN-13 & PBC-12 & PBCN-11)

PBCN-11 and PBC-12 Patient panels come with a military socket for connection to the patient pear push Nurse Call Switch (PB-03).

PBCN-11 has an additional Cancel/Presence switch whereas PBC-12 has a Nurse Call switch next to the socket.

PBCN-13 has a Nurse Call and a Cancel/Presence switch and no military socket.



PBCN13

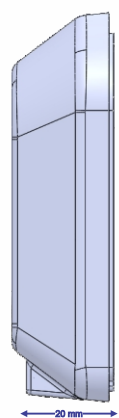

PBC12

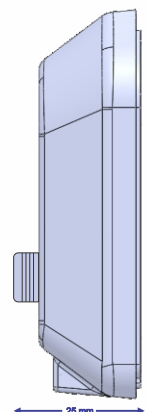

PBCN11

Technical Specifications:

Weight	PBCN-13: 61 g	PBC -12:68 g	PBCN -11:69 g
Dimensions	W:80 mm	H:80 mm	D: 20 mm
Raw Material	Polycarbonate + ABS		
Color	White		
Connection	5-Pin Military Gx16 (Male)		
Power Supply	12 V		
Port	5-Pin Male (Gx16-5) Military connector		
Operating Temperature	-10°C ~ +50° C		
Operating Humidity	30% ~ 80% RH		
Mounting	Flush/Surface		