

BASIC NCS-Cancel/Presence Switch (CBN -11)

CBN-11 is a Cancel/Presence switch usually installed by the door of the patients' room. It can cancel the Nurse Calls activated from the Patient's handset (PB-02), Pull Cord Switch (TB12) or Patient Console Switches (PBCN-13 & PBC-12).

The nurse will use CBN-11 after a call has been taken care of and there is no more activated call associated with the room.

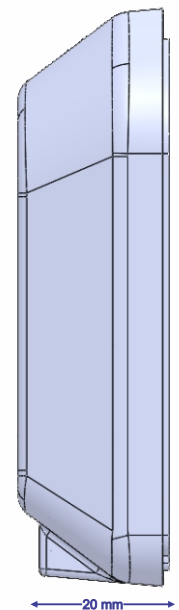

Technical Specifications:

Weight	58 g		
Dimensions	W: 80 mm	H: 80 mm	D: 20 mm
Raw Material	Polycarbonate + ABS		
Color	White		
Power Supply	12 V		
Operating Temperature	-10°C ~ +50° C		
Operating Humidity	30% ~ 80% RH		
Mounting	Surface/Flush		